

## Upgrade Existing Vehicle Scales for Improved Accuracy and Reliability



### Versatile Upgrade

Model VKR210 conversion kits are versatile enough to be installed easily under a variety of existing weighbridges. They use POWERCELL load cells to replace older weighing components such as mechanical lever systems, type "S" lever systems, analog load cells, and CapCheck load cells (shown at left).



### Complete Kit

Model VKR210 is a complete kit that contains everything needed to convert a scale for fully electronic weighing: POWERCELL load cells, cables, receivers, mounting plates, anti-rotation pins, shims, and junction boxes.



### Durable Cables

All cables are double-shielded with stainless steel protection against environmental and rodent damage. A glass-to-metal load cell connector forms a water-tight seal quickly, making replacement easy.



### Tailored Service

METTLER TOLEDO provides the installation, calibration, and maintenance services needed to ensure that your scale will weigh accurately and reliably throughout its lifetime.



### VKR210 Load Cell Conversion Kit

Give your existing weighbridge the advantage of reliable POWERCELL technology with a Model VKR210 load cell conversion kit. This easy-to-install kit upgrades a weighbridge by using POWERCELL load cells to replace high-maintenance lever systems, analog load cells, or CapCheck load cells. Each POWERCELL load cell contains a microprocessor that monitors cell performance, adjusting for environmental influences and instantly notifying the scale operator of any weighing errors. POWERCELL load cells have a proven history of accurate and reliable performance. They provide exceptional value by meeting the real-world demands of heavy-capacity industrial weighing.

## VKR210 Load Cell Conversion Kit

| Features                     | Benefits   |
|------------------------------|--|
| POWERCELL Load Cell          | Produces a strong, reliable signal.<br>Built-in microprocessor automatically compensates for environmental influences.<br>Built-in diagnostics simplify service and maintenance.<br>Water-tight canister for harsh environments. |
| Self-Aligning Suspension     | Provides accurate, repeatable weighing.  |
| Compression Mounting         | Simple design with no mechanical levers or extra components to become worn or misaligned.  |
| Stainless Steel Junction Box | Extra protection for harsh environments.   |
| Stainless Steel Cables       | Durable cables keep working in harsh conditions.   |
| Glass-to-Metal Connectors    | Quick-connect cables make replacement easy.  |

| Load Cell Specifications |  |
|--------------------------|--|
| Capacities               | MTX: 25t (55,000 lb) and 45t (100,000 lb)<br>760: 90t (200,000 lb)     |
| Suspension               | Rocker column, compression   |
| Material                 | Canister: 304 stainless steel<br>Load element: 17-4 PH stainless steel |
| Environmental Protection | IP68/IP69K   |
| NTEP Approval            | NIST H44 IIL-M 10,000d (CC# 88-091A4)                                  |
| OIML Approval            | R60 C3, C4, C5, C6 (MTX: TC5408, 760: TC2149)                          |
| Factory Mutual Approval  | MTX: ID# 3004084, 760: OV4A2.AX  |
| Ex Approval              | MTX: KEMA 03ATEX1166, KEMA 03ATEX1250<br>760: Ex-94.C.101              |

### Options

- Checking systems
- Riser base plates
- Home run cable
- Lightning protection
- Scale terminal
- Vehicle scale software
- Remote display



Optional IND310 scale terminal

### VKR210 Assemblies

Each VKR210 kit contains everything needed to convert a weighbridge to POWERCELL technology:

- POWERCELL load cells
- Cables
- Receivers
- Mounting plates
- Anti-rotation pins
- Shims
- Junction boxes
- Additional hardware (if needed)

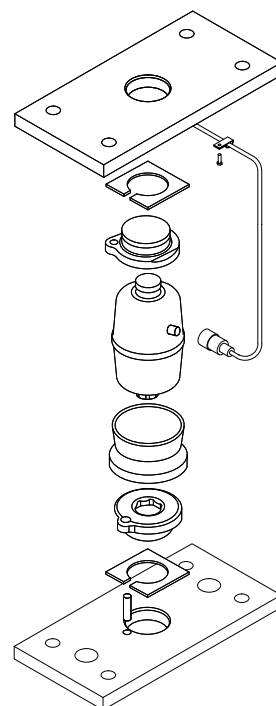

Standard 25t/45t assembly is shown above. Some other assemblies include additional hardware.

### Height of Assembly (without shims)

25t and 45t: 10¼ in. (260 mm)  
90t: 14 in. (356 mm)

### Height of Assembly

25t CapCheck: 10½ in. (265 mm)  
45t CapCheck: 13½ in. (333 mm)



Produced in a facility that is



### Mettler-Toledo, Inc.

1900 Polaris Parkway  
Columbus, Ohio 43240  
Tel. (800) 786-0038  
(614) 438-4511  
Fax (614) 438-4900

Specifications subject to change without notice.  
© 2008 Mettler-Toledo, Inc.  
2M0208  
I08-TR03475.0E

[www.mt.com](http://www.mt.com)

For more information